

PRECISION ANGULAR CONTACT BALL BEARINGS

TYPE 7005CTA/HQ1P4S HCB7005 C T P4S UL  
PRECISION P4S  
CERAMIC BALL

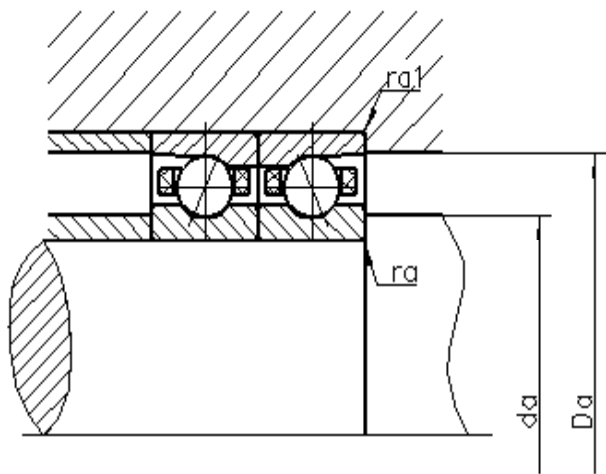
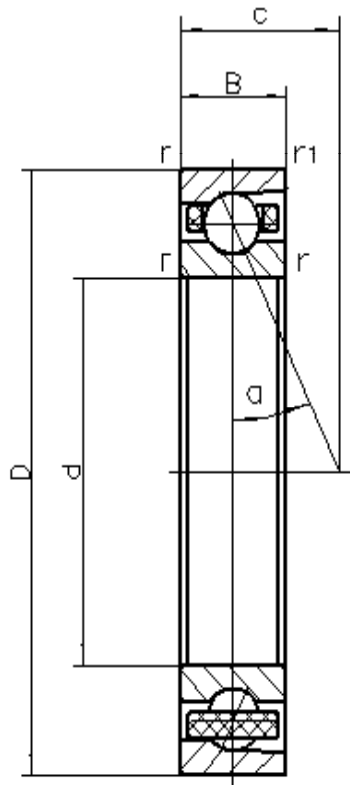

d	25	mm	
D	47	mm	
B	12	mm	
c	10.8	mm	
Da	42	mm	Tolerance: H12
da	30	mm	Tolerance: h12
r <sub>min</sub>	0.6	mm	
r <sub>l min</sub>	0.3	mm	
ra <sub>max</sub>	0.6	mm	
ra <sub>l max</sub>	0.3	mm	
α	15°		Contact angle
m	0.065	kg	Mass
Cr	12280	N	Basic dynamic load rating, radial
Cor	5600	N	Basic static load rating, radial
Fv <sub>L</sub>	59	N	Preload force
Fv <sub>M</sub>	150	N	Preload force
Fv <sub>H</sub>	290	N	Preload force
Ca <sub>L</sub>	33.6	N/um	Axial rigidity
Ca <sub>M</sub>	50.1	N/um	Axial rigidity
Ca <sub>H</sub>	68	N/um	Axial rigidity
Limiting speeds	70000	r/min	Lubrication: oil
	45000	r/min	Lubrication: grease