

# PRECISION ANGULAR CONTACT BALL BEARINGS



TYPE 7011CTA/HQ1P4S HCB7011 C T P4S UL

PRECISION P4S

CERAMIC BALL

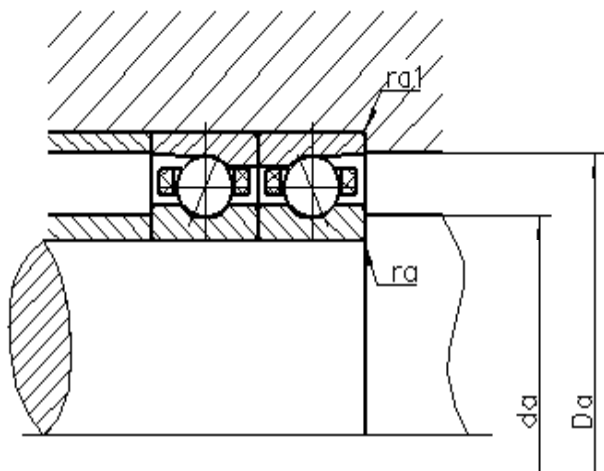
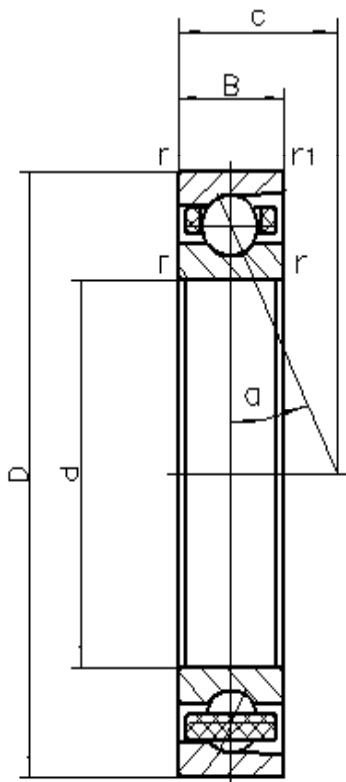

d	55	mm	
D	90	mm	
B	18	mm	
c	18.7	mm	
Da	83	mm	Tolerance: H12
da	62	mm	Tolerance: h12
r <sub>min</sub>	1.1	mm	
r <sub>l min</sub>	0.6	mm	
ra <sub>max</sub>	1	mm	
ra <sub>l max</sub>	0.6	mm	
α	15°		Contact angle
m	0.312	kg	Mass
Cr	34120	N	Basic dynamic load rating, radial
Cor	20050	N	Basic static load rating, radial
Fv <sub>L</sub>	200	N	Preload force
Fv <sub>M</sub>	490	N	Preload force
Fv <sub>H</sub>	980	N	Preload force
Ca <sub>L</sub>	70.5	N/um	Axial rigidity
Ca <sub>M</sub>	103	N/um	Axial rigidity
Ca <sub>H</sub>	141.7	N/um	Axial rigidity
Limiting speeds	34000	r/min	Lubrication: oil
	22000	r/min	Lubrication: grease