

# PRECISION ANGULAR CONTACT BALL BEARINGS

|           |                  |                       |
|-----------|------------------|-----------------------|
| TYPE      | 7011AC-2RZTA/P4S | B7011 E 2RSD T P4S UL |
| PRECISION | P4S              |                       |

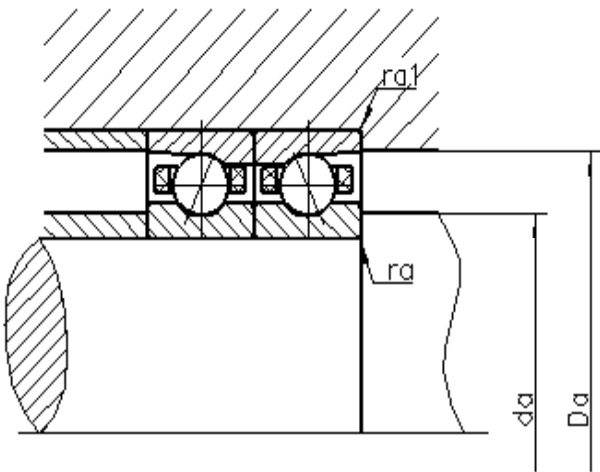
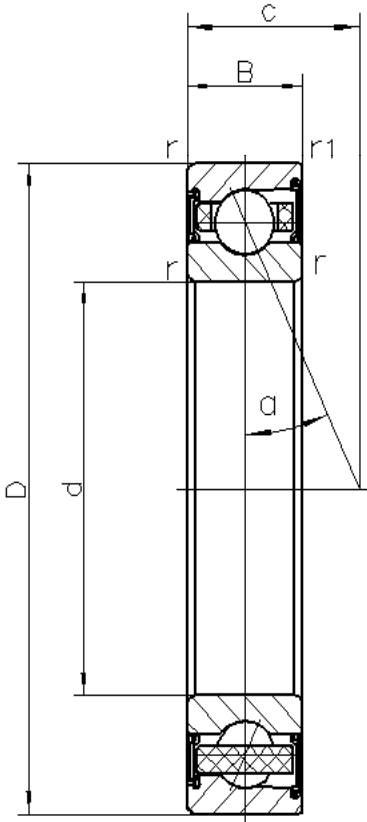

|                          |       |       |                                   |
|--------------------------|-------|-------|-----------------------------------|
| <b>d</b>                 | 55    | mm    |                                   |
| <b>D</b>                 | 90    | mm    |                                   |
| <b>B</b>                 | 18    | mm    |                                   |
| <b>c</b>                 | 25.9  | mm    |                                   |
| <b>Da</b>                | 83    | mm    | Tolerance: H12                    |
| <b>da</b>                | 62    | mm    | Tolerance: h12                    |
| <b>r<sub>min</sub></b>   | 1.1   | mm    |                                   |
| <b>rl<sub>min</sub></b>  | 0.6   | mm    |                                   |
| <b>ra<sub>max</sub></b>  | 1     | mm    |                                   |
| <b>ral<sub>max</sub></b> | 0.6   | mm    |                                   |
| <b>α</b>                 | 25°   |       | Contact angle                     |
| <b>m</b>                 | 0.377 | kg    | Mass                              |
| <b>Cr</b>                | 32350 | N     | Basic dynamic load rating, radial |
| <b>Cor</b>               | 27150 | N     | Basic static load rating, radial  |
| <b>Fv<sub>L</sub></b>    | 340   | N     | Preload force                     |
| <b>Fv<sub>M</sub></b>    | 780   | N     | Preload force                     |
| <b>Fv<sub>H</sub></b>    | 1570  | N     | Preload force                     |
| <b>Ca<sub>L</sub></b>    | 158.1 | N/um  | Axial rigidity                    |
| <b>Ca<sub>M</sub></b>    | 215.3 | N/um  | Axial rigidity                    |
| <b>Ca<sub>H</sub></b>    | 283.3 | N/um  | Axial rigidity                    |
| <b>Limiting speeds</b>   | 14000 | r/min | Lubrication: grease               |