

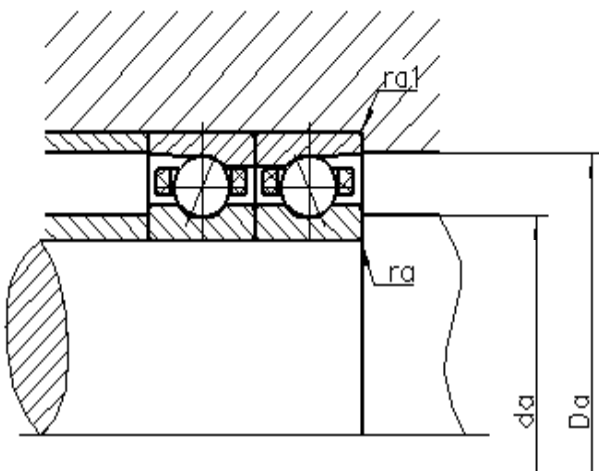

```

TYPE          71905AC-2RZTA/P4S      B71905 E 2RSD T P4S UL
PRECISION          P4S

```

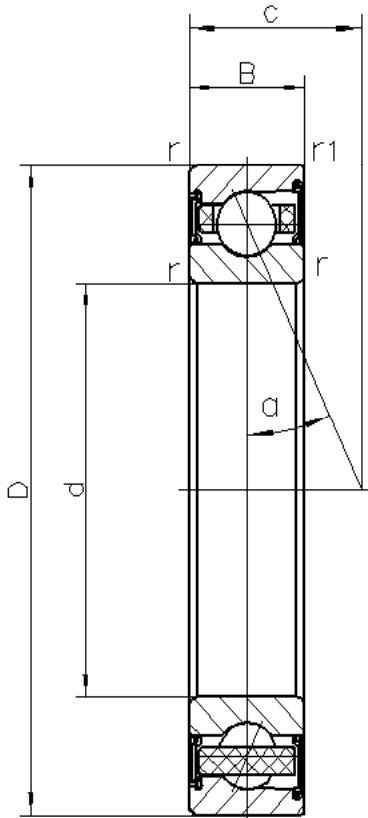

d	25	mm	
D	42	mm	
B	9	mm	
c	12.3	mm	
Da	38.5	mm	Tolerance: H12
da	28.5	mm	Tolerance: h12
r_{min}	0.3	mm	
r1_{min}	0.15	mm	
ra_{max}	0.3	mm	
ra1_{max}	0.15	mm	
α	25°		Contact angle
m	0.043	kg	Mass
Cr	7430	N	Basic dynamic load rating, radial
Cor	5140	N	Basic static load rating, radial
Fv_L	69	N	Preload force
Fv_M	150	N	Preload force
Fv_H	290	N	Preload force
Ca_L	66.5	N/um	Axial rigidity
Ca_M	88.9	N/um	Axial rigidity
Ca_H	115.1	N/um	Axial rigidity
Limiting speeds	32000	r/min	Lubrication: grease