

PRECISION ANGULAR CONTACT BALL BEARINGS

TYPE 71916CTA/P4S B71916 C T P4S UL
PRECISION P4S

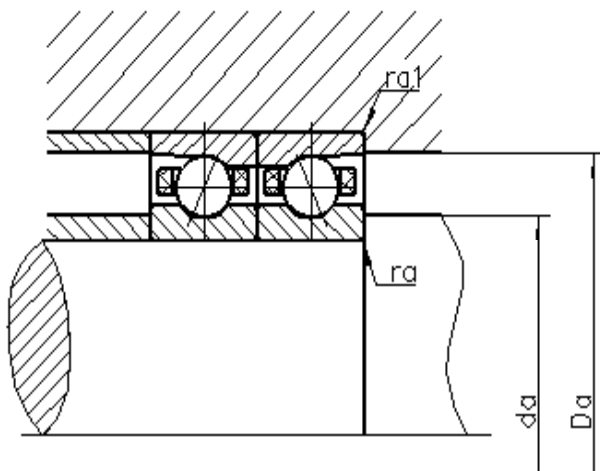
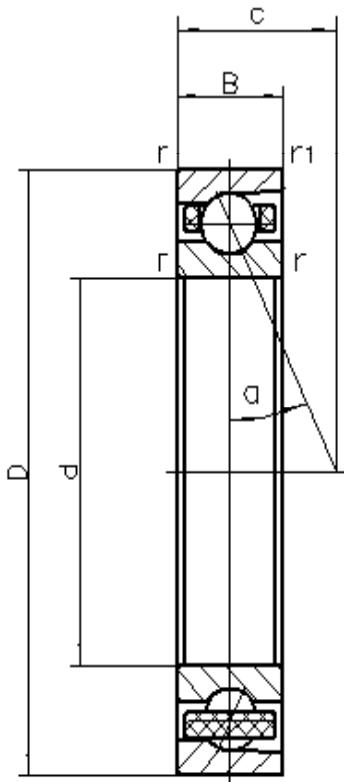

d	80	mm	
D	110	mm	
B	16	mm	
c	20.7	mm	
Da	104	mm	Tolerance: H12
da	86	mm	Tolerance: h12
r _{min}	1	mm	
r _{l min}	0.3	mm	
r _{a max}	0.6	mm	
r _{al max}	0.3	mm	
α	15°		Contact angle
m	0.376	kg	Mass
Cr	33640	N	Basic dynamic load rating, radial
Cor	34560	N	Basic static load rating, radial
Fv _L	200	N	Preload force
Fv _M	490	N	Preload force
Fv _H	980	N	Preload force
Ca _L	74.2	N/um	Axial rigidity
Ca _M	108.5	N/um	Axial rigidity
Ca _H	149.6	N/um	Axial rigidity
Limiting speeds	18000	r/min	Lubrication: oil
	11000	r/min	Lubrication: grease