

# PRECISION CYLINDRICAL ROLLER BEARINGS

TYPE NN3006KM/W33-SP

PRECISION SP

Double row, with 1:12 taper bore

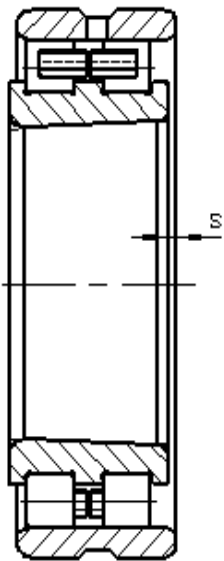
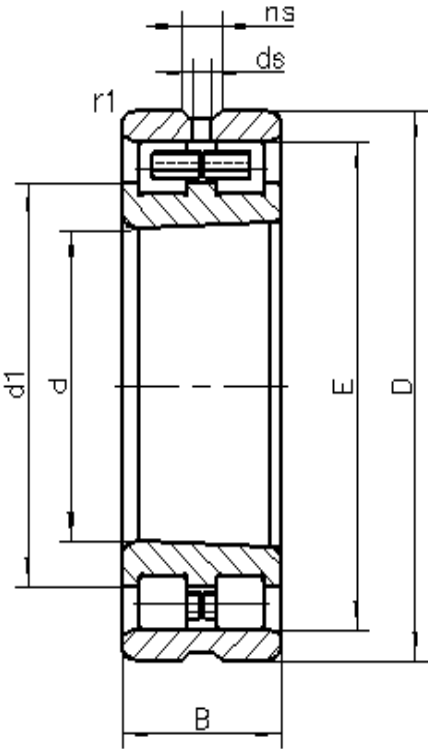

d	30	mm	
D	55	mm	
B	19	mm	
Da	50	mm	Tolerance: H12
da	37.5	mm	Tolerance: h12
r1 min	1	mm	
ra1 max	1	mm	
E	48.5	mm	
dl	38.9	mm	
ns	3.5	mm	
ds	2	mm	
s	1	mm	Axial displacement facility from centre position
m	0.19	kg	Mass
Cr	30700	N	Basic dynamic load rating, radial
Cor	37000	N	Basic static load rating, radial
Limiting speeds	19000	r/min	Lubrication: oil
	16000	r/min	Lubrication: grease

