

PRECISION CYLINDRICAL ROLLER BEARINGS

TYPE NN3007KM/W33-SP

PRECISION SP

Double row, with 1:12 taper bore

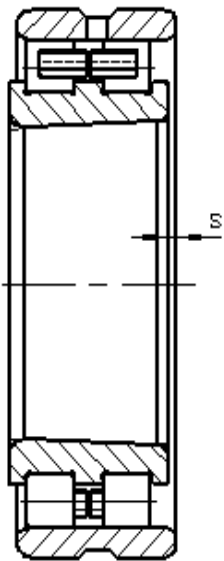
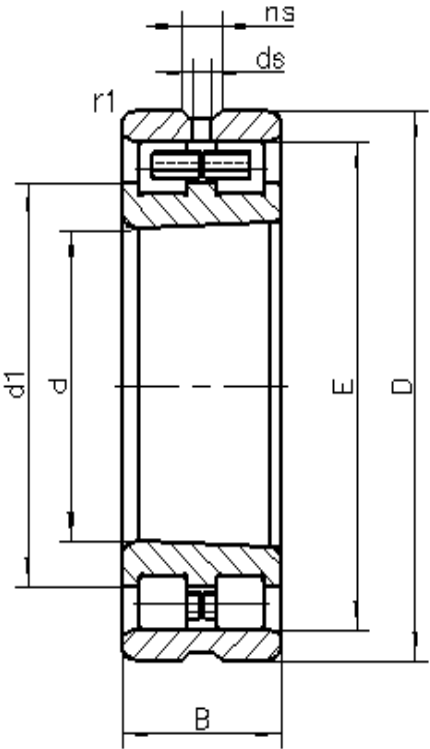

d	35	mm	
D	62	mm	
B	20	mm	
Da	57	mm	Tolerance: H12
da	43	mm	Tolerance: h12
r1 min	1	mm	
ra1 max	1	mm	
E	55	mm	
dl	45.4	mm	
ns	5	mm	
ds	2.5	mm	
s	1.2	mm	Axial displacement facility from centre position
m	0.25	kg	Mass
Cr	38100	N	Basic dynamic load rating, radial
Cor	48200	N	Basic static load rating, radial
Limiting speeds	17000	r/min	Lubrication: oil
	14000	r/min	Lubrication: grease

