

PRECISION CYLINDRICAL ROLLER BEARINGS

TYPE NN3008KM/W33-SP

PRECISION SP

Double row, with 1:12 taper bore

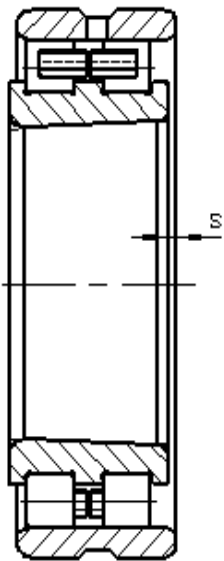
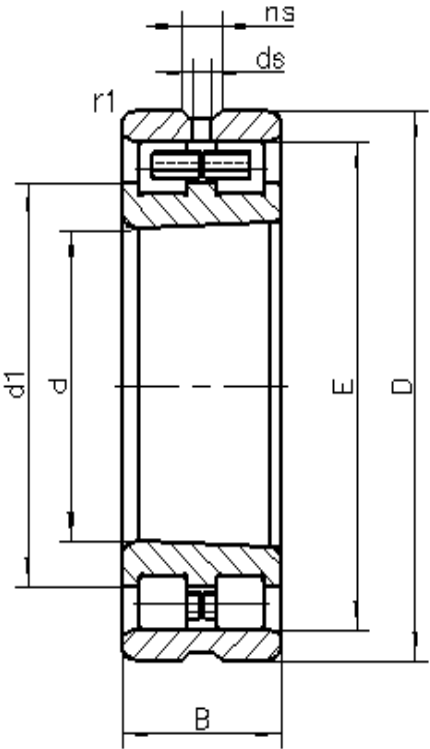

d	40	mm	
D	68	mm	
B	21	mm	
Da	63	mm	Tolerance: H12
da	48	mm	Tolerance: h12
r1 min	1	mm	
ra1 max	1	mm	
E	61	mm	
dl	50.6	mm	
ns	5	mm	
ds	2.5	mm	
s	1.2	mm	Axial displacement facility from centre position
m	0.3	kg	Mass
Cr	43300	N	Basic dynamic load rating, radial
Cor	55400	N	Basic static load rating, radial
Limiting speeds	15000	r/min	Lubrication: oil
	12000	r/min	Lubrication: grease

