

PRECISION CYLINDRICAL ROLLER BEARINGS

TYPE NN3013KM/W33-SP

PRECISION SP

Double row, with 1:12 taper bore

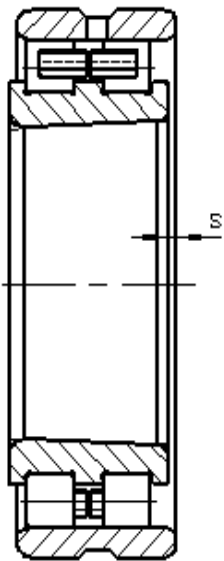
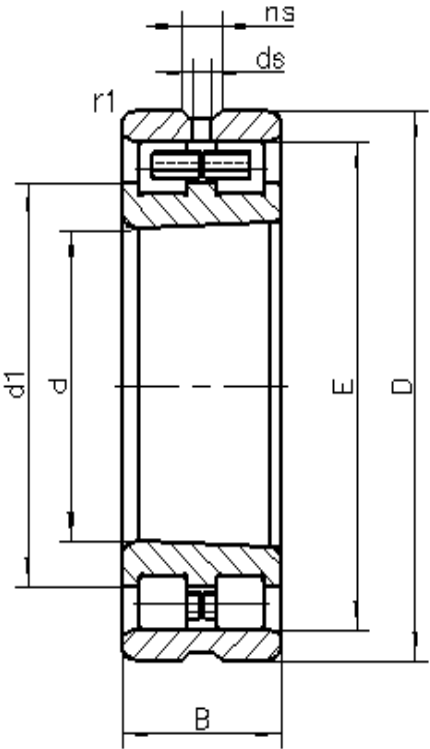

d	65	mm	
D	100	mm	
B	26	mm	
Da	93	mm	Tolerance: H12
da	75	mm	Tolerance: h12
r1 min	1.1	mm	
ra1 max	1	mm	
E	91	mm	
dl	78.2	mm	
ns	5	mm	
ds	2.5	mm	
s	1.1	mm	Axial displacement facility from centre position
m	0.71	kg	Mass
Cr	78700	N	Basic dynamic load rating, radial
Cor	119100	N	Basic static load rating, radial
Limiting speeds	9500	r/min	Lubrication: oil
	8000	r/min	Lubrication: grease

