

# PRECISION CYLINDRICAL ROLLER BEARINGS

TYPE NN3020KM/W33-SP

PRECISION SP

Double row, with 1:12 taper bore

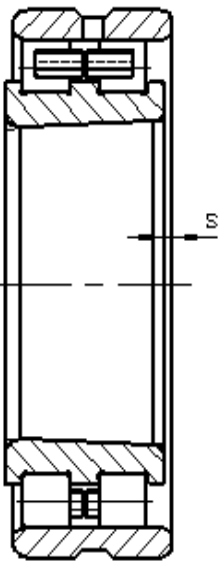
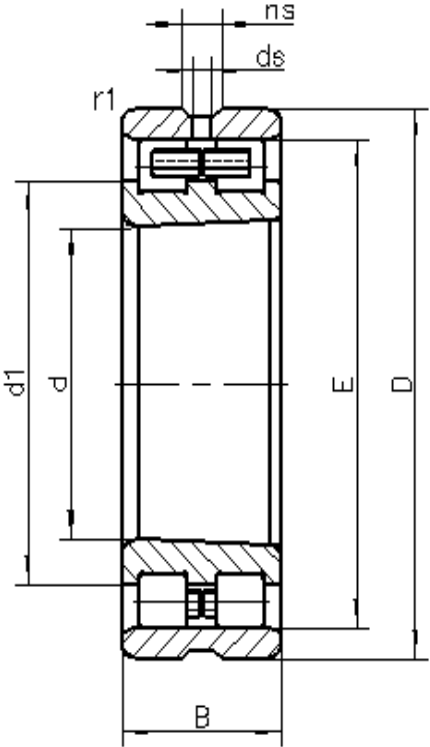

d	100	mm	
D	150	mm	
B	37	mm	
Da	140	mm	Tolerance: H12
da	115	mm	Tolerance: h12
r1 min	1.5	mm	
ra1 max	1.5	mm	
E	137	mm	
dl	119.5	mm	
ns	6.5	mm	
ds	3.2	mm	
s	1.45	mm	Axial displacement facility from centre position
m	2.23	kg	Mass
Cr	151000	N	Basic dynamic load rating, radial
Cor	254000	N	Basic static load rating, radial
Limiting speeds	6300	r/min	Lubrication: oil
	5300	r/min	Lubrication: grease

