

PRECISION CYLINDRICAL ROLLER BEARINGS

TYPE NN3026KM/W33-SP

PRECISION SP

Double row, with 1:12 taper bore

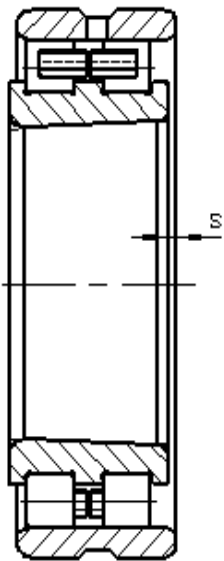
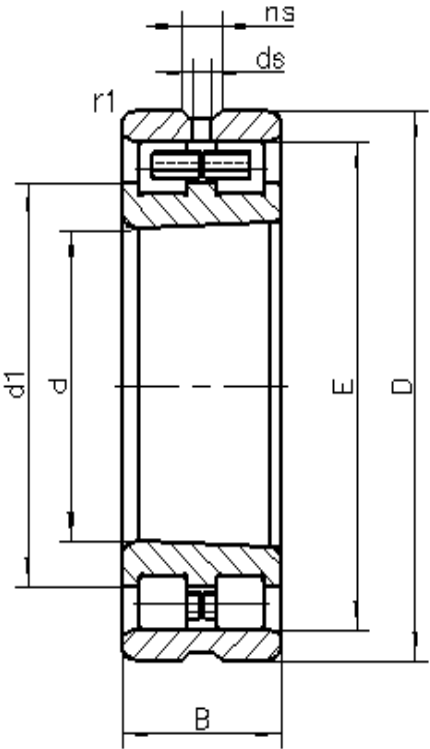

d	130	mm	
D	200	mm	
B	52	mm	
Da	186	mm	Tolerance: H12
da	150	mm	Tolerance: h12
r1 min	2	mm	
ra1 max	2	mm	
E	182	mm	
dl	156.5	mm	
ns	8	mm	
ds	4	mm	
s	2.5	mm	Axial displacement facility from centre position
m	5.78	kg	Mass
Cr	284000	N	Basic dynamic load rating, radial
Cor	476000	N	Basic static load rating, radial
Limiting speeds	4500	r/min	Lubrication: oil
	3800	r/min	Lubrication: grease

