

PRECISION CYLINDRICAL ROLLER BEARINGS

TYPE NN3028KM/W33-SP

PRECISION SP

Double row, with 1:12 taper bore

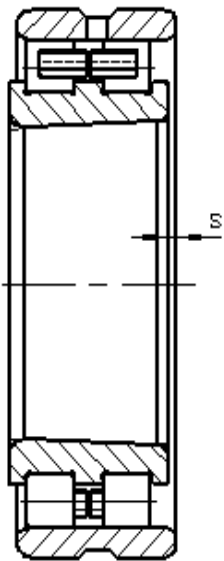
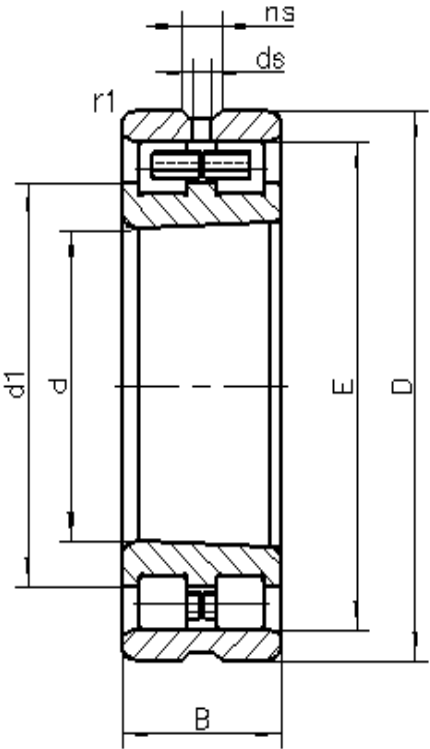

d	140	mm	
D	210	mm	
B	53	mm	
Da	196	mm	Tolerance: H12
da	160	mm	Tolerance: h12
r1 min	2	mm	
ra1 max	2	mm	
E	192	mm	
dl	166.5	mm	
ns	9	mm	
ds	4.5	mm	
s	2.75	mm	Axial displacement facility from centre position
m	6.02	kg	Mass
Cr	291000	N	Basic dynamic load rating, radial
Cor	502000	N	Basic static load rating, radial
Limiting speeds	4300	r/min	Lubrication: oil
	3600	r/min	Lubrication: grease

